

# Class "A" distribution building for lease ±70,000 s.f. available

Transal Corporate Park  
2750 NW 84 Avenue | Doral, Florida 33122



## Building specifications:

- ±70,000 s.f. available for lease situated on 3.59 acres
  - ±62,220 s.f. of warehouse space
  - ±7,780 s.f. of office space
- 21 dock positions; 1 ramp
- 22' clear ceiling height
- ±55 parking spaces
- Occupancy: Q3 2017
- Close proximity to Palmetto Expressway (SR-826), Dolphin Expressway (SR-836), and Florida Turnpike Extension
- Institutionally owned and professionally managed

Contact our office for pricing...



For further information, please contact our exclusive agents:

Steve Medwin, SIOR, CCIM

T. 305.350.0923

[steve.medwin@ngkf.com](mailto:steve.medwin@ngkf.com)

Nick Wigoda, SIOR

T. 305.982.4110

[nick.wigoda@ngkf.com](mailto:nick.wigoda@ngkf.com)

# Class "A" distribution building for lease ±70,000 s.f. available

Transal Corporate Park  
2750 NW 84 Avenue | Doral, Florida 33122

## Building plan

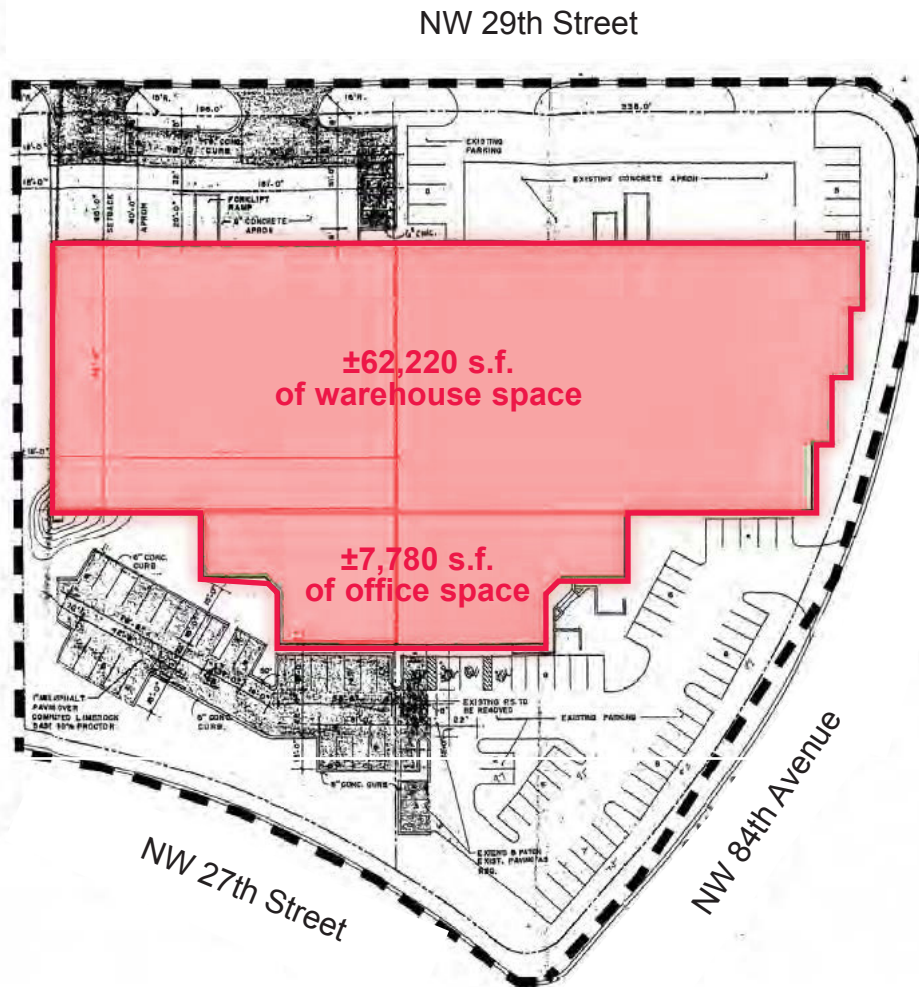

For further information, please contact our exclusive agents:

Steve Medwin, SIOR, CCIM

T. 305.350.0923

[steve.medwin@ngkf.com](mailto:steve.medwin@ngkf.com)

Nick Wigoda, SIOR

T. 305.982.4110

[nick.wigoda@ngkf.com](mailto:nick.wigoda@ngkf.com)