

EASTVIEW COMMERCE CENTER

±47,545 SF AVAILABLE FOR LEASE



2420 NW 116th Street
MIAMI, FL 33167



±47,545 SF
Warehouse



15 Dock Doors
1 Ramp



±32'
Clear Height



Build-To-Suit
Office/Showroom

PLEASE CONTACT:

Steven J. Medwin, SIOR, CCIM

Executive Managing Director

t 305-350-0923

steve.medwin@nmrk.com

Nick Wigoda, SIOR

Executive Managing Director

t 305-982-4110

nick.wigoda@nmrk.com

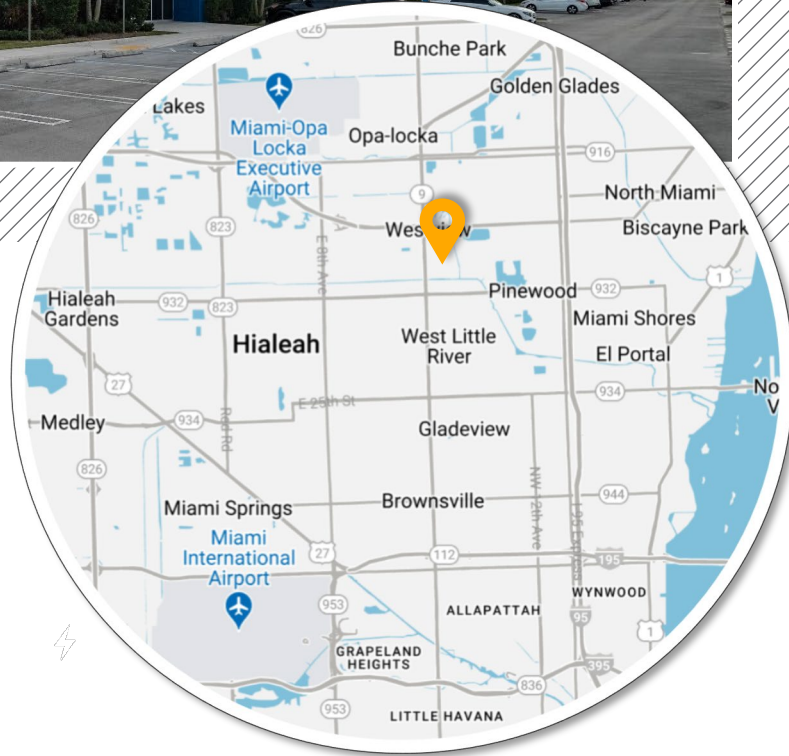

PROPERTY FEATURES

- ±47,545 SF Available for Lease
- Fully HVAC Warehouse
- Fully secured ±800,000 SF Class A Business Park with gated access along with nights and weekends security
- Build-To-Suit Offices
- Abundant Parking Spaces
- ±32' Clear Height
- 51' x 42' Column Spacing with 60' Speed Bays
- Four (4) Docks per Bay
- 185' Shared Truck Court
- ESFR Fire Protection
- LED Lighting

FLOOR PLAN

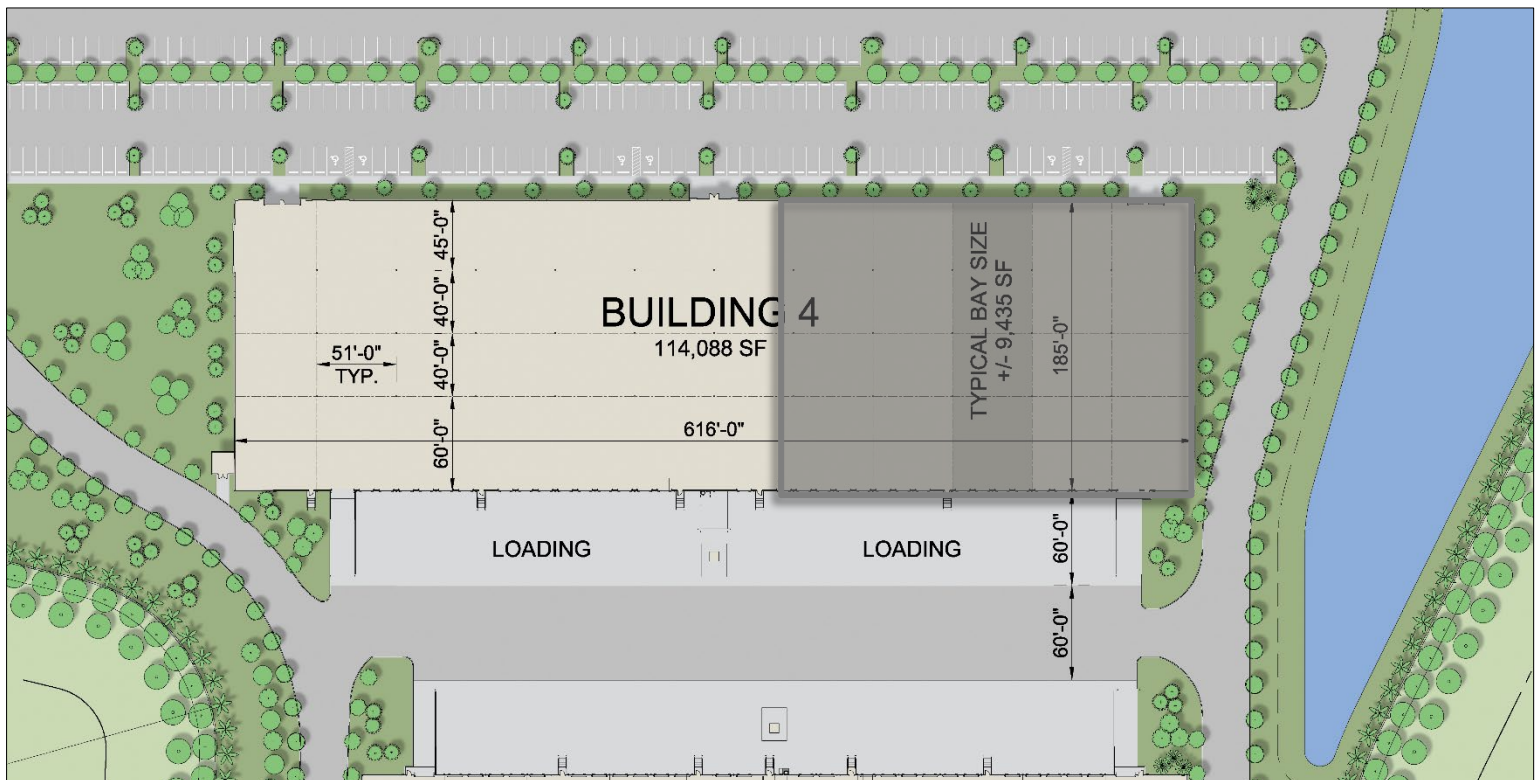

PLEASE CONTACT:

Steven J. Medwin, SIOR, CCIM

Executive Managing Director

t 305-350-0923

steve.medwin@nmrk.com

Nick Wigoda, SIOR

Executive Managing Director

t 305-982-4110

nick.wigoda@nmrk.com



PLEASE CONTACT:

Steven J. Medwin, SIOR, CCIM

Executive Managing Director

t 305-350-0923

steve.medwin@nmrk.com

Nick Wigoda, SIOR

Executive Managing Director

t 305-982-4110

nick.wigoda@nmrk.com

LOCATION



Steven J. Medwin, SIOR, CCIM

Executive Managing Director
t 305-350-0923
steve.medwin@nmrk.com

Nick Wigoda, SIOR

Executive Managing Director
t 305-982-4110
nick.wigoda@nmrk.com